

SECTION A-A'



30-34 OXFORD STREET | SAWN BLUESTONE PAVING TO PROPERTY FRONTAGES | RAISED PLANTING BED WITH TREE GROVE | CENTRAL TIMBER DECK WITH TIMBER SEATING AREA | SAWN BLUESTONE PAVING TO PROPERTY FRONTAGES | 22 DERBY STREET

SECTION B-B'



30-34 OXFORD STREET | SAWN BLUESTONE PAVING TO PROPERTY FRONTAGES | FEATURE PLANTING BED | CENTRAL TIMBER DECK | MOUNDED GRASSED AREA FOR RELAXATION | SAWN BLUESTONE PAVING TO PROPERTY FRONTAGES | 22 DERBY STREET

SECTION C-C'



DERBY STREET | EXTEND PLANTING INTO DERBY STREET | FOOTPATH | TIMBER SEATING ALONG DERBY STREET | MOUNDED GRASSED AREA FOR RELAXATION | TIMBER SEATING ORIENTED TO DEFINE INTIMATE GATHERING SPACES | RAISED PLANTING BED WITH TREE GROVE | FOOTPATH | LANGRIDGE STREET

CROSS SECTIONS

NEW PUBLIC OPEN SPACE FOR OXFORD STREET, COLLINGWOOD



Timber seating and mounded grassed area for relaxation



Mounded grassed area

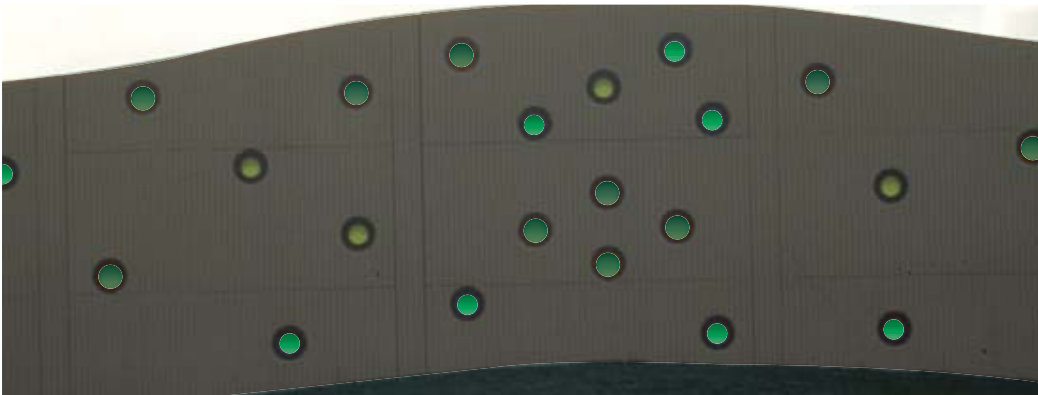

WSUD opportunities



Feature lighting opportunities



Planting opportunities (including food producing planting)

Raised feature planting bed

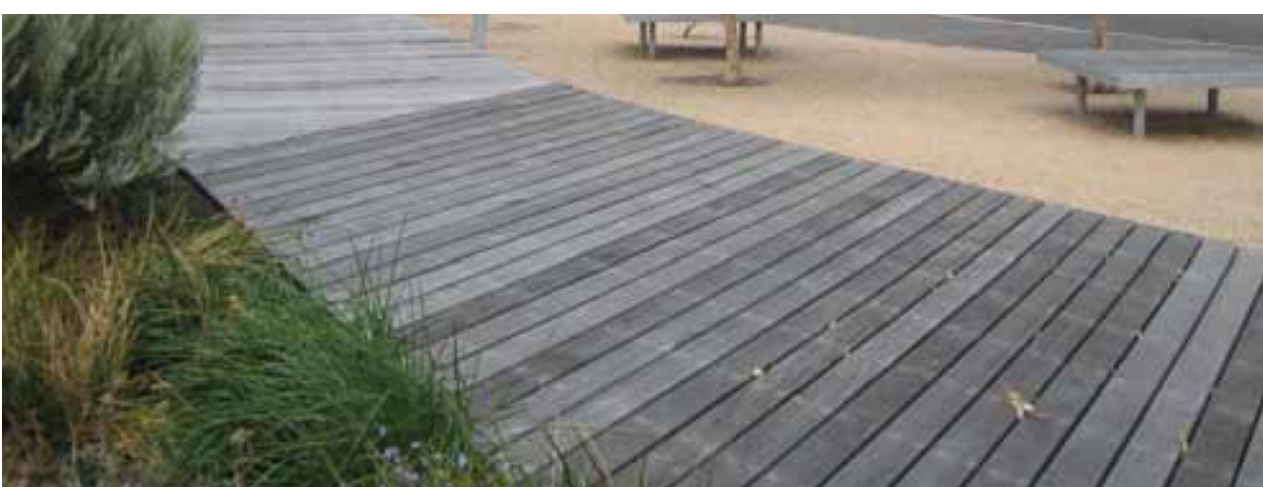

Central timber decking



Sawn bluestone paving to property frontages

INDICATIVE MATERIALS

NEW PUBLIC OPEN SPACE FOR OXFORD STREET, COLLINGWOOD

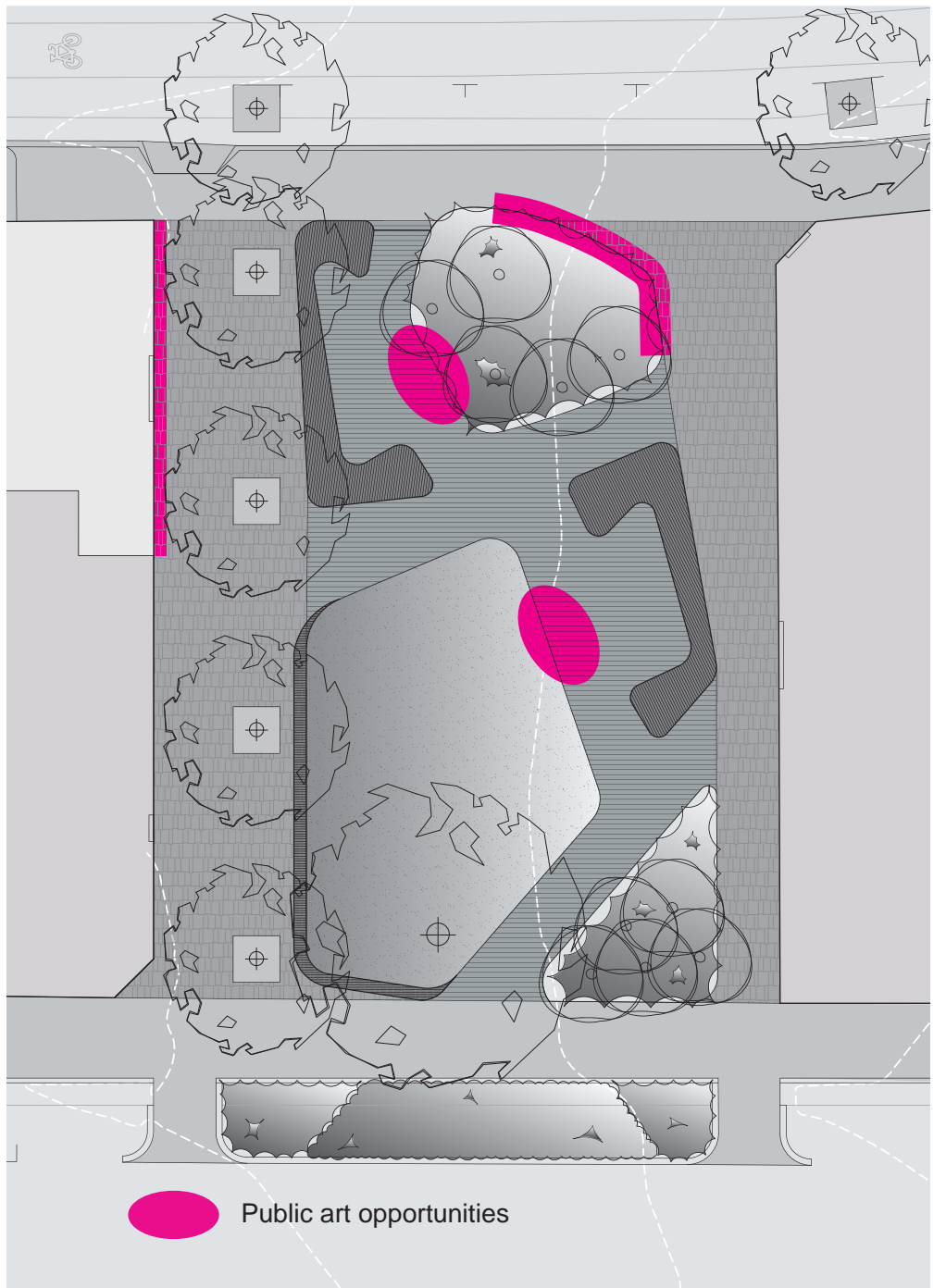
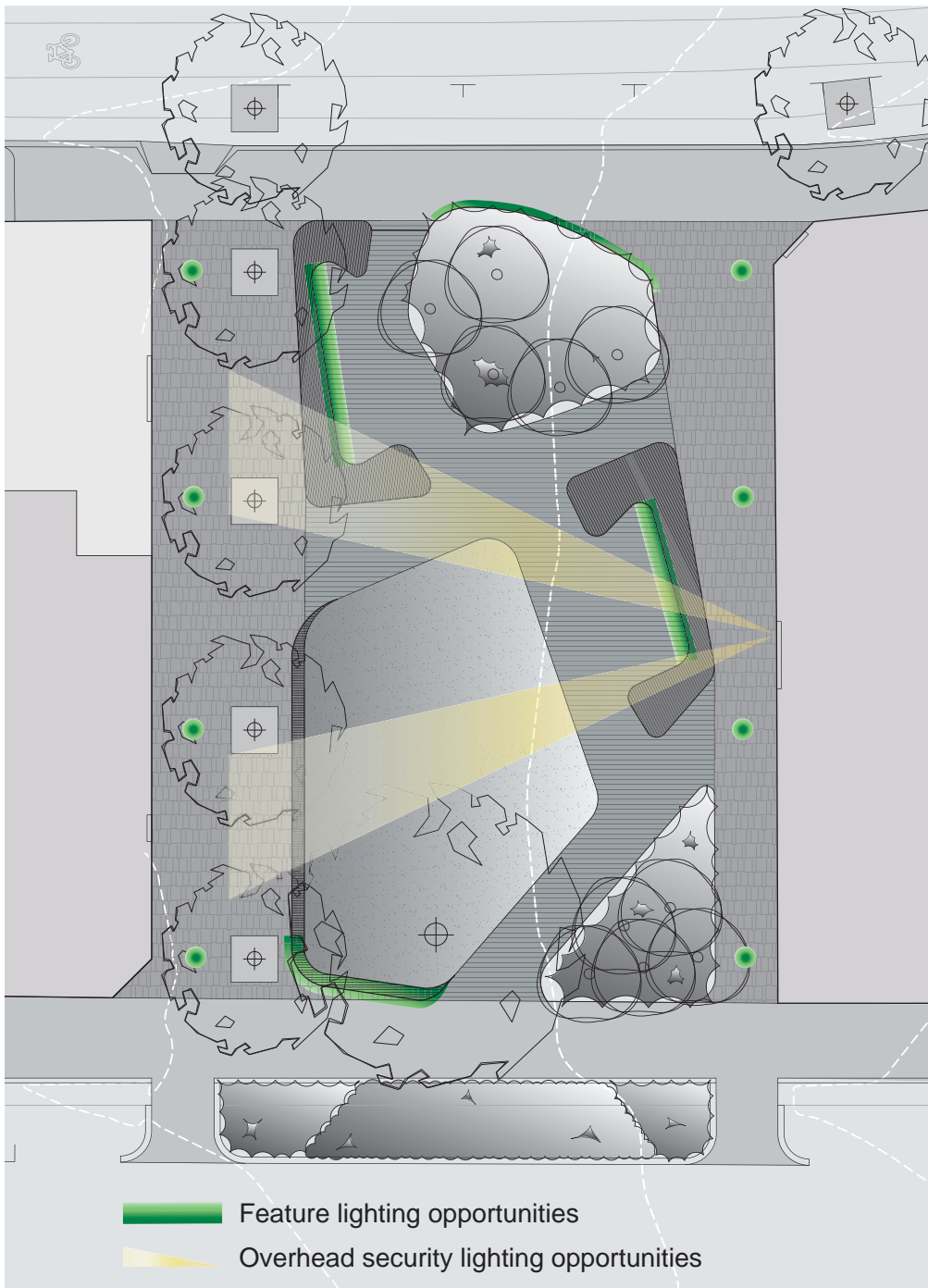
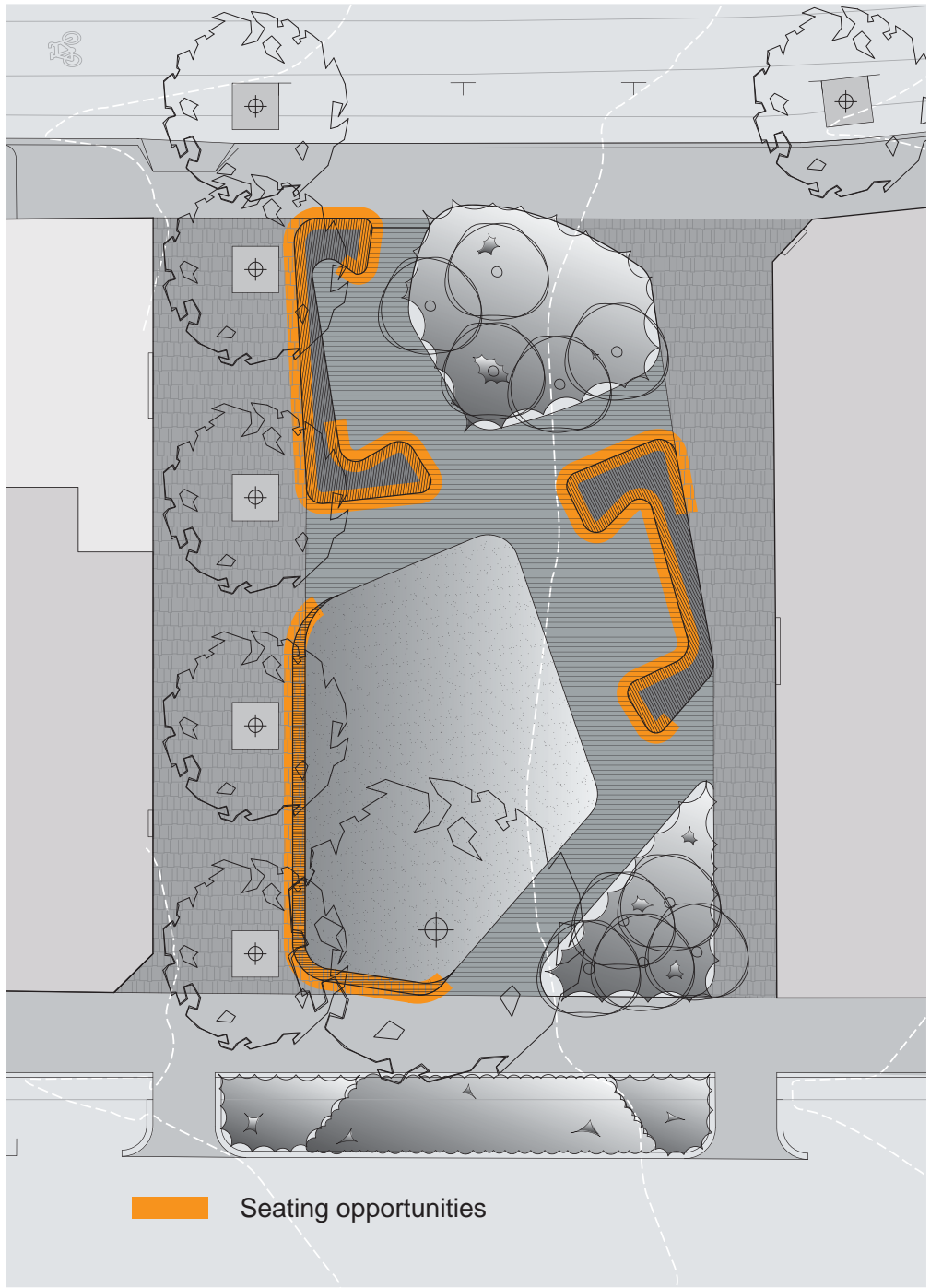
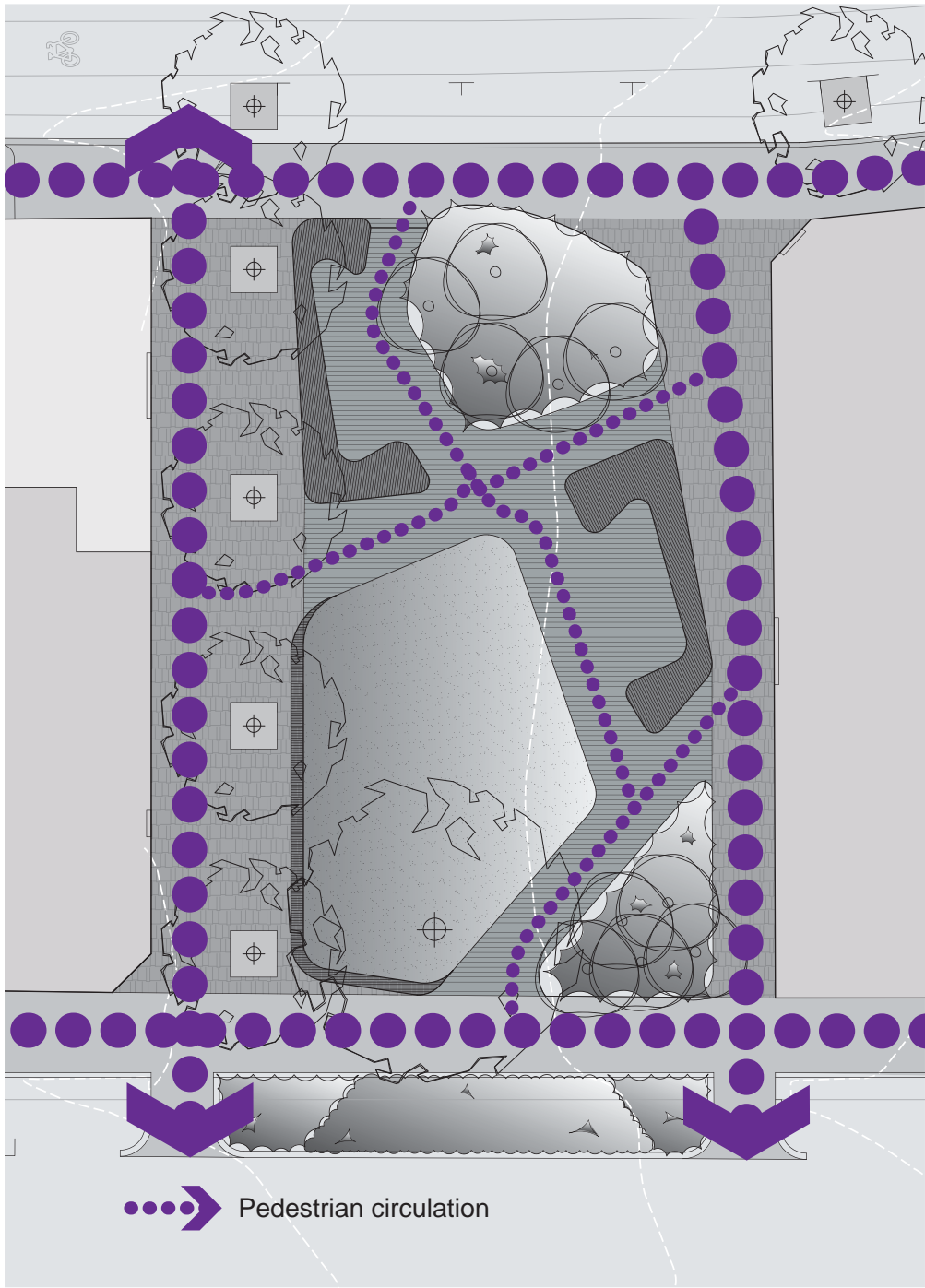

DESIGN OVERLAYS
NEW PUBLIC OPEN SPACE FOR OXFORD STREET, COLLINGWOOD